

Standard Features

- ✓ Stainless Steel Frames
- ✓ Clear View Curved or Square Glass
- ✓ Non Tilt Tray Sliders
- ✓ Choice of Castors or Legs
- ✓ Top and Front LED Lighting
- ✓ Choice of Many Standard Laminates
- ✓ Fan Assisted Air Circulation
- ✓ Digital Temp Control and Display
- ✓ New Cabinet Feature for Easy Cleaning
- ✓ Chrome Wires Included
- ✓ Full Length Door Hinge



Also Available

- ✓ Dual Temperature Cabinets
- ✓ New Square Glass Profile
- ✓ Extra Shelving
- ✓ Timber and Veneer Finishing
- ✓ Extra Wide Tops
- ✓ Front Rails
- ✓ Matching Till and Benches
- ✓ Combination of Modules

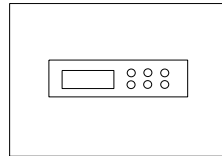

Easy to adjust digital controller

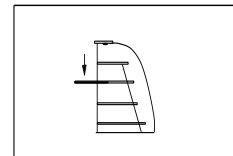

Non tilt tray supports

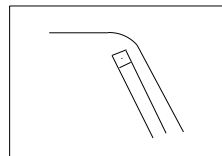

New front lights

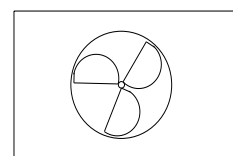

Fan assisted air circulation

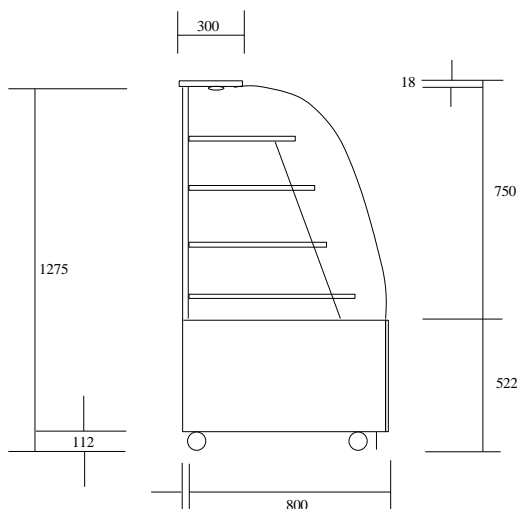

Dimensions

- 1 Module: 750 x 820 x 1275
- 1 Module 1200 x 820 x 1275
- 1 Module: 950 x 820 x 1275
- 2 Module: 1475 x 820 x 1275
- 2 Module: 1875 x 820 x 1275

Power

Heated Cabinets all 15 amp